

Your better choice for High Bay lighting

FYT 150W LED Tube light



A Revolutionary Lighting solution

Feature

- IP65, Explosion-proof
- Suitable for 6 or 8 meter height
- 15000 Lumen
- High quality Meanwell driver
- 3 Year warranty



Why LED & LED 150W LED Tube is better than traditional lights?

1 Beam angle

150W LED Tube beam angle:180degree

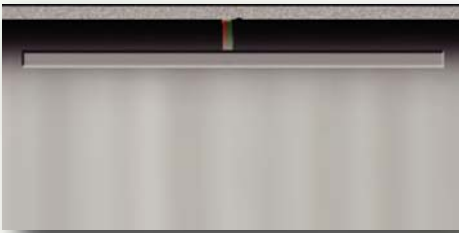

2 Heat dissipation.

150W LED Tube heat dissipation area
dimension 114cmx6cm
150W LED Tube LED chips tempreature:68 C



3 IP Grade:IP65.



Surrounding silicon pads make 150W
LED tube IP65

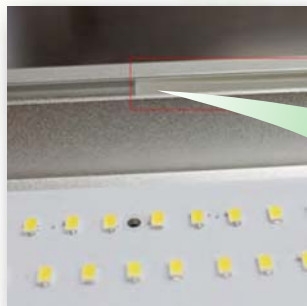

IP65 150W LED TUBE can be used in more places.

4 Higher lumens

150W LED tube

15000 lumen



5 High reliable Power Driver--Meanwell with UL,TUV certification.

Product specification

Model No.	P65-150W
Size	L1198mm*W150mm*H72mm
Input Power	150W
Luminous Flux	15000lm
Input Voltage	AC 100-277V 50/60Hz
LED Quantify	360pcs SMD2835
CCT	3000K/4000K/6000K
CRI	>80
Net Weight	6.0kg
Package	L1250xW250xH215 mm/2pcs per box
Gross Weight	8 kg (1pcs/box) 13 kg (2pcs/box)



Lighting the World

Photometric Data of Lamp

Lamp Description

Lamp Name: FYT-T150W-CW
Lamp Type:
Light Type:
Light Standard:

Lamp Size:
Rated Voltage:
Light Number:
Light Area:

Lamp Weight:
Rated Power:
Rated Flux:
Light Flux:

Measured Data of Lamp

Voltage: 220.8 V	Current: 0.721 A	Power: 154.4 W	Power Factor: 0.969
Total Flux	15188.70 lm	Central Intensity	5296.18 cd
Lamp Efficiency	0.00%	Light Efficiency	98.37 lm/W
Peak Intensity	5367.78 cd	Location of Peak(c,γ)	(180.0°, 5.4°)
Half-Intensity Angle	110.7°	BeamAngle	163.8°
Upward Light Ratio	0	Downward Light Ratio	100%
Upward Street Side	0	Downward Street Side	7536.02 lm
Upward House Side	0	Downward House Side	7652.80 lm
Flash Area(76°)	0 cm ²	Discomfort Glare(SLI)	0

Distribution Curve of Meridian

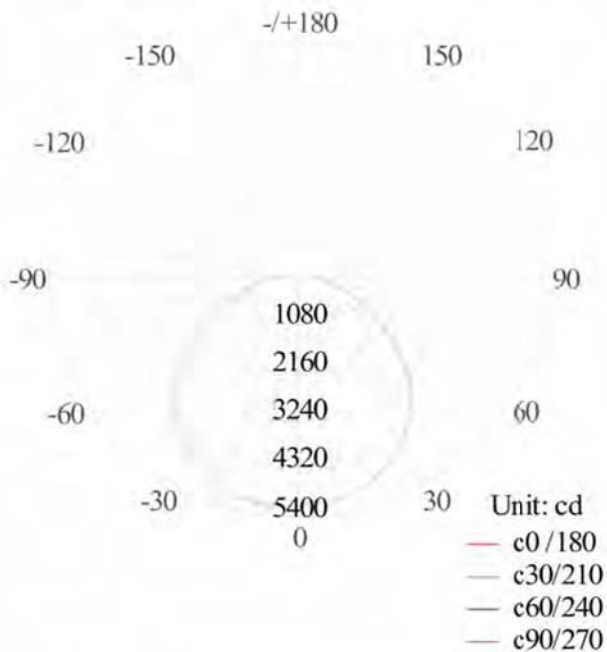

Conical Intensity Distribution Curve of Max Intensity

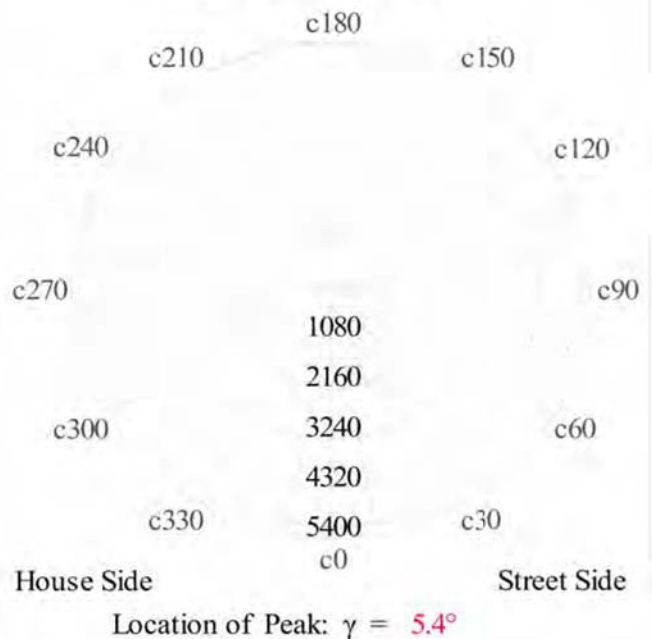

c Range: 0-360 Degree
c Interval: 10 Degree
Test Speed: Fast
Test Distance: 8.0 m

γ Range: 0-90 Degree
γ Interval: 0.9 Degree
Test Date: 2013-05-23
Test Time: 14-50-01

Temperature: 20 Celsius
Humidity: 50%
Test No.:
Tester:

cd/1000 lm Curve

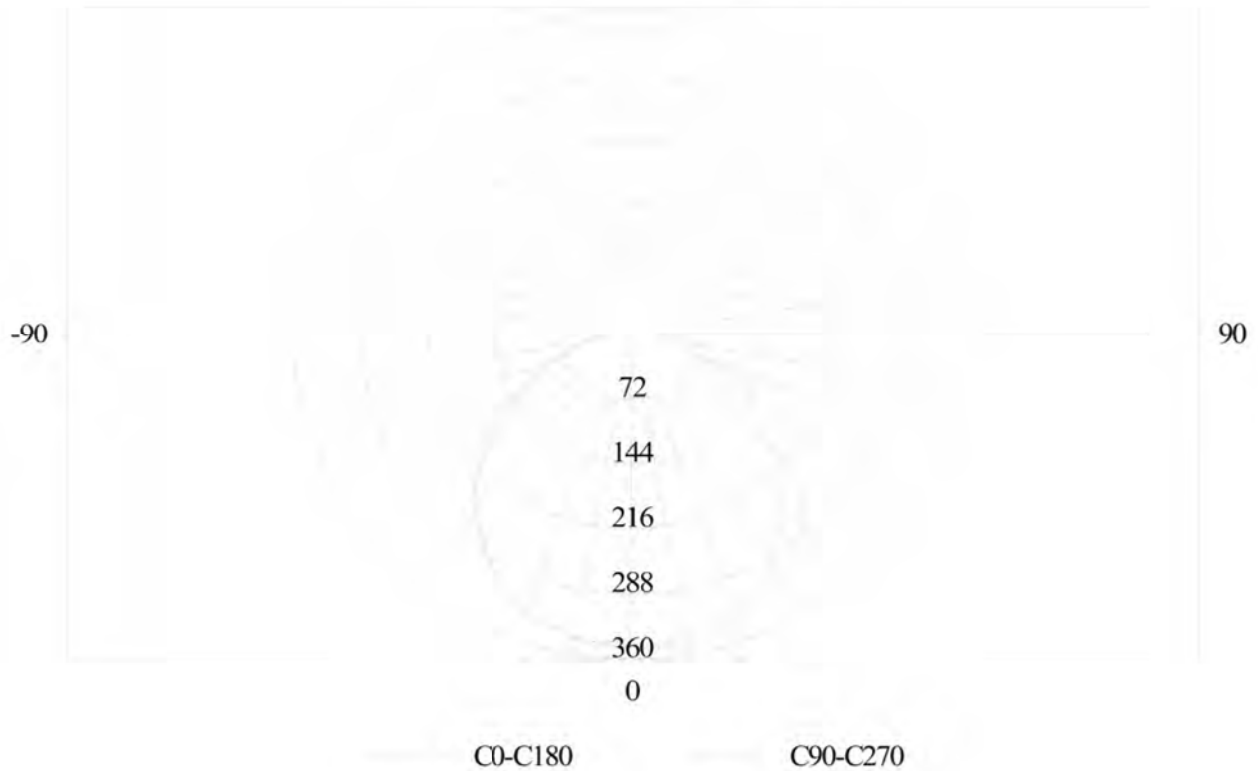

Illumination Cone Curve

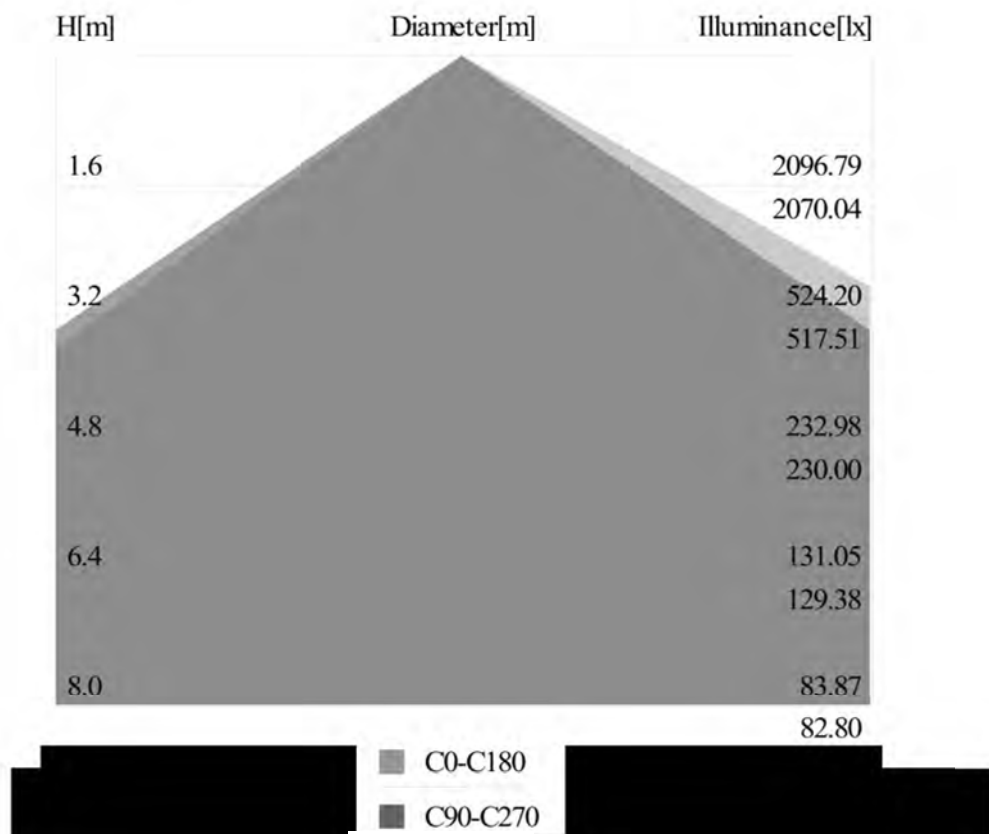

150W LED TUBE



N°	Type	E_m [lx]	E_{min} [lx]	E_{max} [lx]	E_{min} / E_m	E_{min} / E_{max}	$E_{h.m.} / E_m$	H [m]	Cam
1	perpendicular	174	162	187	0.93	0.87	/	0.000	/

Installation

1 The installation method of stainless fittings

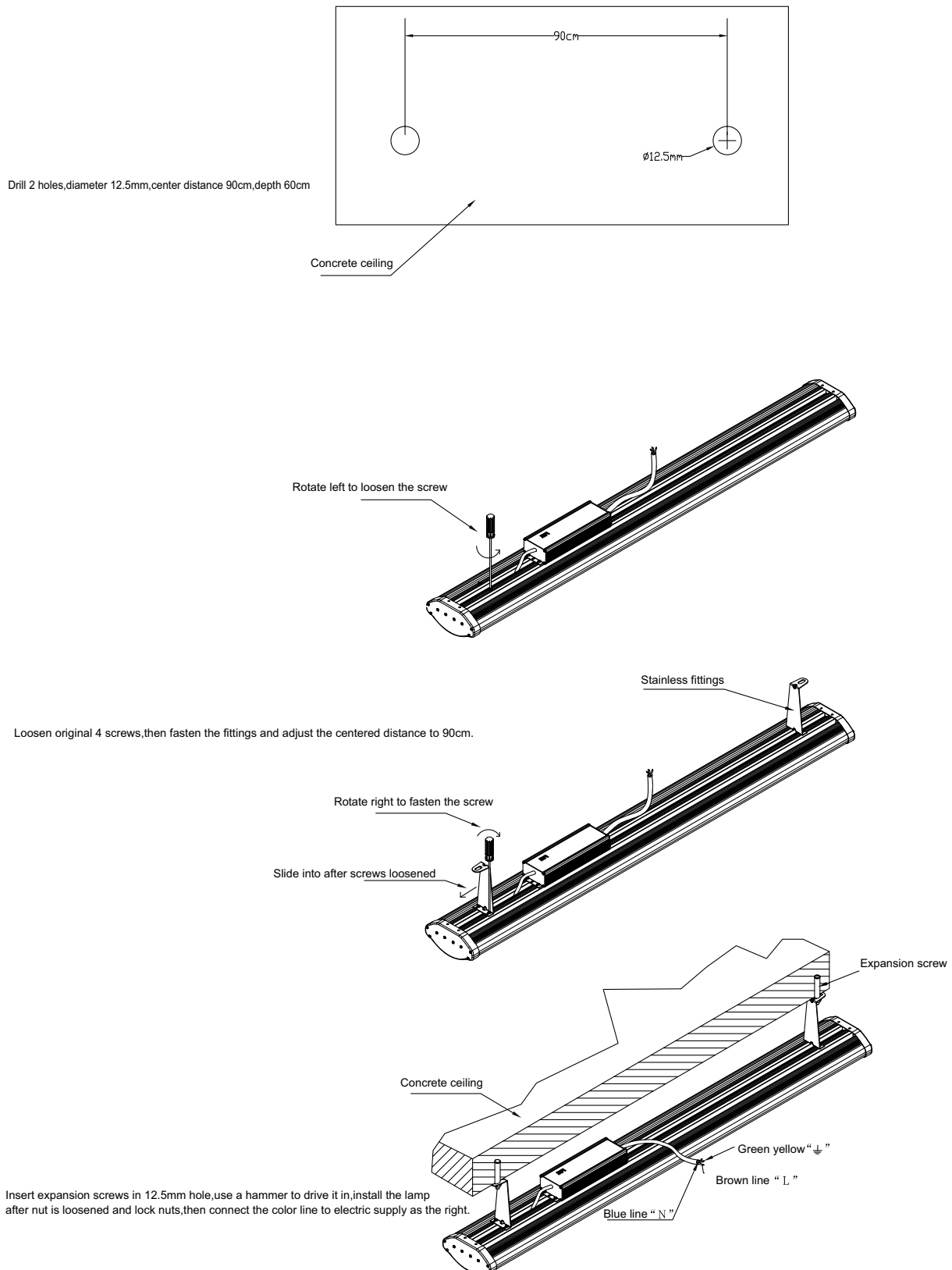

2 The installation method of hanging rope

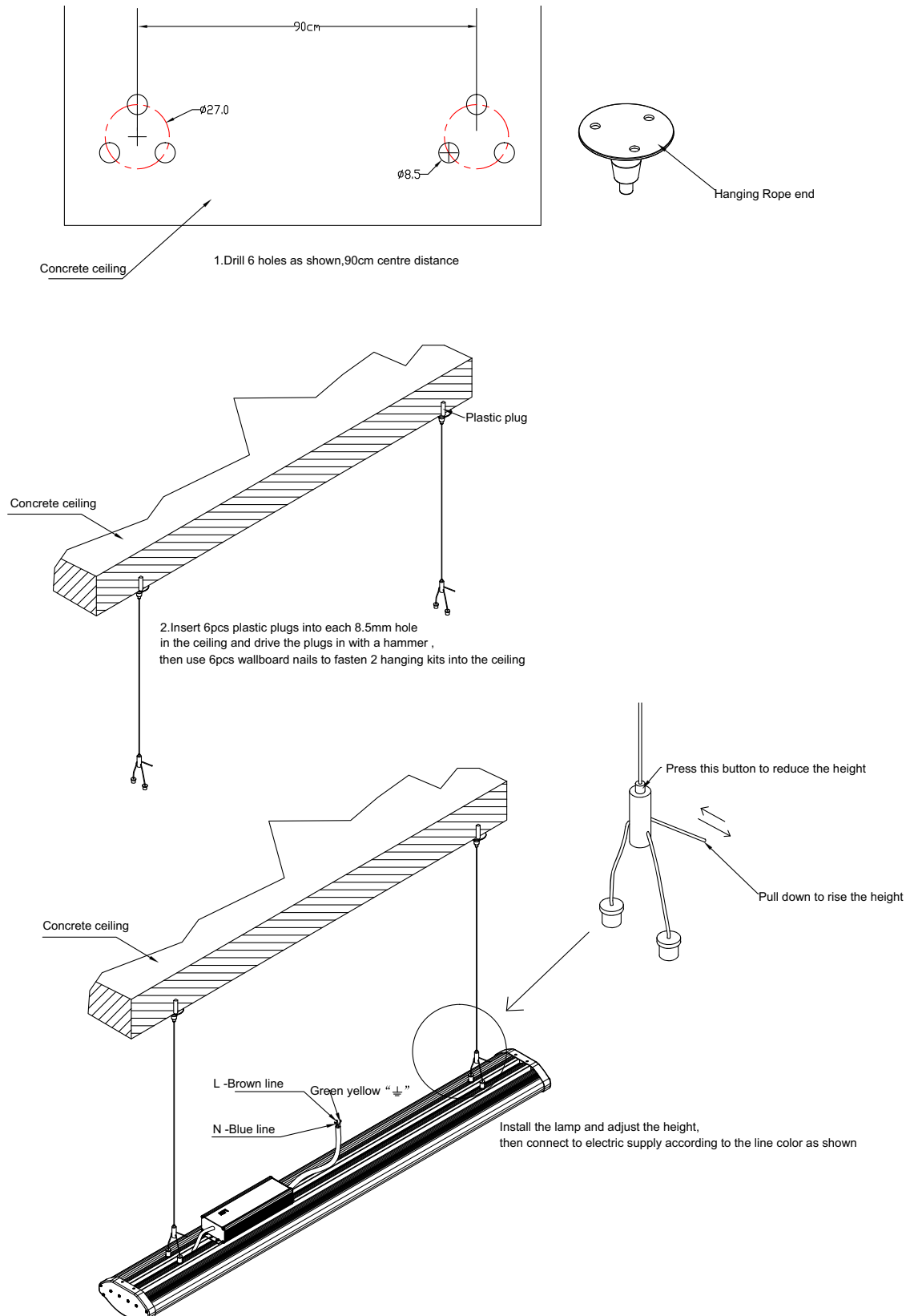

Application:

- warehouse
- production line
- bus station
- airport

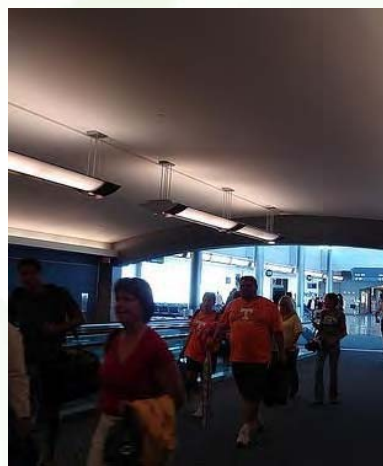
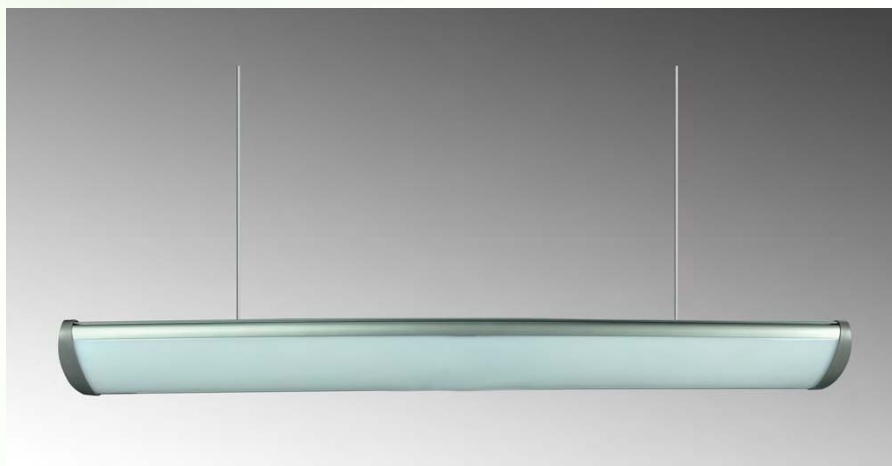

LED & LED

Tel:+46 73 679 35 50

<http://www.ledandled.se>

Email:info@ledochled.se

★ We reserve the right to revise or update its product specifications.