

Datesheet HighBay light

- ▼ When you need to install or disassemble this light, you must turn off the power and have professionals work
- ▼ Our products comply with CIE 127: 2007; IEC 62031: 2008; IEC / PAS 62612: 2009 international standard
- ▼ All products company warranty policy statement as our website; and this document will describe the warranty period



Product: HighBay Light

150W

	Item	Parameters	Unit
Power	Input voltage	AC90-265/277	V
	Watt	150±1%	W
	Input Current	0.72	A
	Frequency	50/60	Hz
	Driver	Isolated constant current	
	PF	≥0.97	
light	Lamp beads	196	PCS
	Fulx	21000±200	lm
	CCT	2800-6500	K
	CRI	Ra≥70	
	Chip	Philips 3030	
	Beam angle	60°, 90°, 120°	(Deg)
characteristics	Material	Aluminum+PC	
	Certification	CE RoHS TUV	
	Work Environment	-20--40	°C
	Working Hours	≥50000	H
	Warranty	3	Years
size	Base	Hooks, sling, stents	
	N.W	3.6	kg
	Package Size	38*38*19	cm
	G.W	5.1	Kg

Product and Package:

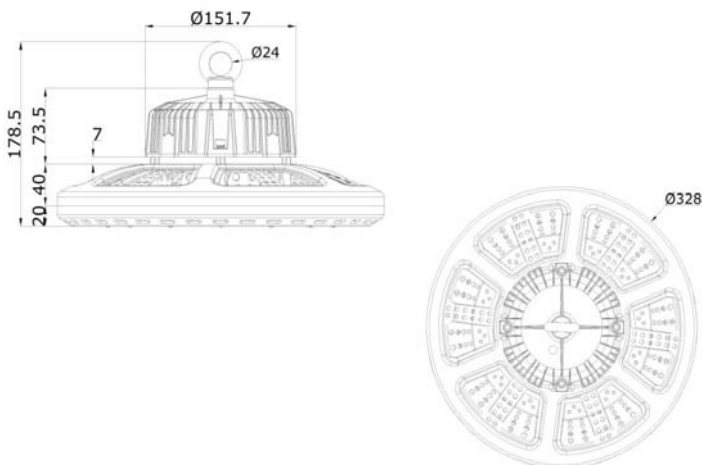

Size: φ328mm*H178.5mm

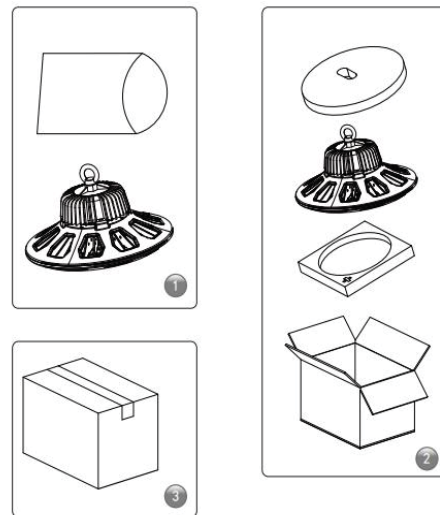

Quantity / Carton	1pcs
Carton Size	38*38*19cm
Gross Weight	5.1KG